

All stainless steel pressure gauge

E-11.18

PBX160XA-MM

“A lot of value for a competitive price”

For the price-conscious buyer

Rugged, durable, safe, reliable, accurate, stock item

Specifications

Case :

Stainless steel AISI 304; Fillable; IP-65

Bayonet ring : polished stainless steel AISI 304

Socket :

Welded to case

1/2" BSP Male / stainless steel AISI 316L

1/2" NPT Male / stainless steel AISI 316L

Includes internal thread to mount restrictor screw for pulsation dampening

Measuring element :

Bourdon tube, stainless steel AISI 316L

Movement :

Stainless steel AISI 304 with min. and max. stops.

Range :

Vacuum, compound

0-0.6 -1'000 bar (0-15-6'000 psi)

Accuracy :

+/-1.0% Full scale or better

Blow-out protection :

Rear mounted with compensation diaphragm

Pointer :

Aluminium, black

Dial :

White face with black printing

Individual serial number for traceability

Scale :

Single (bar) with 1/2" BSP

Dual (bar-psi) with 1/2" NPT

Window :

Laminated safety glass (marked SG)

Fillable :

Yes: Glycerine (t ambient=0°C...+60°C)

Silicone Oil (t ambient=-40...+60°C)

Temperature range :

Ambient: -20°C...+60°C (dry)

Process: +100°C maximum



Range		Range	
[bar]	[psi]	[bar]	[psi]
-1/0 ⁽¹⁾	n/a	0-6	0-100
-1/0.6 ⁽¹⁾	n/a	0-10	0-160
-1/+1.5 ⁽¹⁾	n/a	0-16	0-200
-1/+3 ⁽¹⁾	n/a	0-25	0-300
-1/+5 ⁽¹⁾	n/a	0-40	0-600
-1/+9 ⁽¹⁾	n/a	0-60	0-1'000
-1/+15 ⁽¹⁾	n/a	0-100	0-1'500
0-0.6	n/a	0-160	0-2'000
0-1	0-15	0-250	0-3'000
0-1.6	0-30	0-400	0-6'000
0-2.5	n/a	0-600 ⁽¹⁾	n/a
0-4	0-60	0-1'00 ⁽¹⁾	n/a

⁽¹⁾ BSP thread only - NPT not available in vacuum and compound ranges

Modifications reserved

PBX160XA-MM

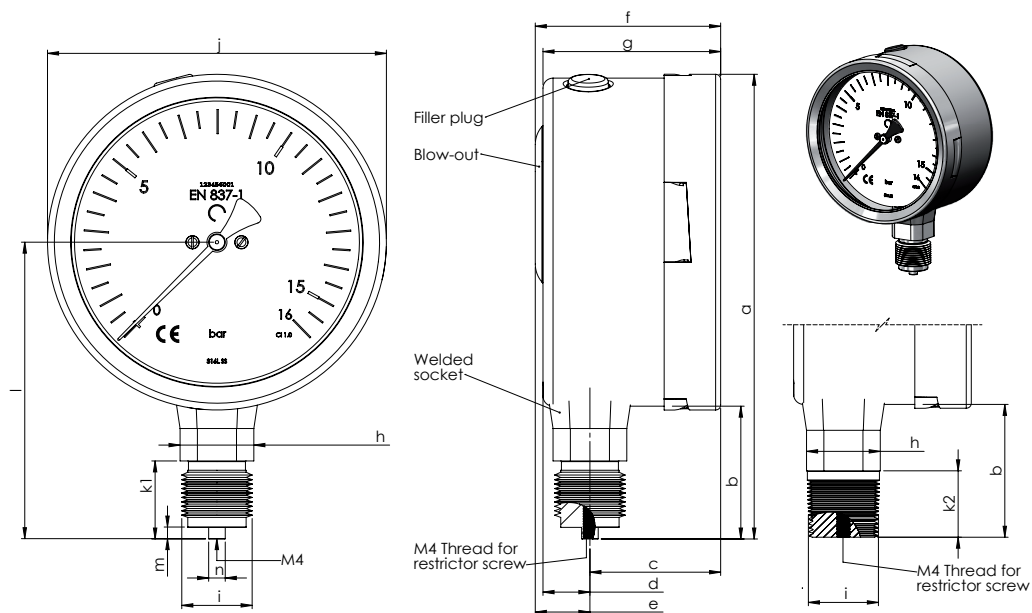

Dim.	Type	a	b	c	d	g	h	i	j	k1	k2	l	m	n	Weight
Metric [mm]	BSP	209	50	35	15	50	Hex 22	1/2" BSP	160	23.5	---	128	3.5	5	1.00 kg
US [inch]		8.23	1.97	1.38	0.59	1.97			6.3	0.93	---	5.04	0.14	0.197	2.20 lb
Metric [mm]	NPT	205	44.5	35	15	50		1/2" NPT	160	---	19	123	---	---	1.00 kg
US [inch]		8.07	1.75	1.38	0.59	1.97			6.3	---	0.75	4.84	---	---	2.20 lb

Modifications reserved



www.rueger.com www.instrugate.com

Manufacturer of Sensors and Gauges for Temperature & Pressure

RÜEGER SA

Ch. de Mongevon 9
Case postale 98
1023 CRISSIER 1
SWITZERLAND

Tel + 41 (0)21 637 32 32
Fax + 41 (0)21 637 32 00
E-mail info@rueger.ch

RÜEGER GmbH

Plieninger Strasse 58
70567 STUTTGART
GERMANY

Tel + 49 (0)711 16-163-0
Fax + 49 (0)711 16-16333
E-mail rgmbh@rueger.com

RÜEGER Sdn Bhd

No. 22-5, Jalan Wangsa Delima 10
D'Wangsa, Wangsa Maju
53300 KUALA LUMPUR
MALAYSIA

Tel + 603 - 4142 3808
Fax + 603 - 4142 3909
E-mail sales@rueger.com.my

RÜEGER SENSORS BEIJING

1012B Kuntai International Center
Chaoyangwai Avenue 12A
Chaoyang District
100164 BEIJING
CHINA

Tel + 86 - 10 5879 0981/2
Fax + 86 - 10 5879 0782